



Floor and Ceiling Plates - Split Type w/Springs

FCP

Technical Features

- **Sizes Available (Nominal)** : To fit pipe diameters from DN15^{1/2"} thru DN200/8"
- **Finish** : Chrome
- **Material** : 1,17mm (0.046") cold rolled steel

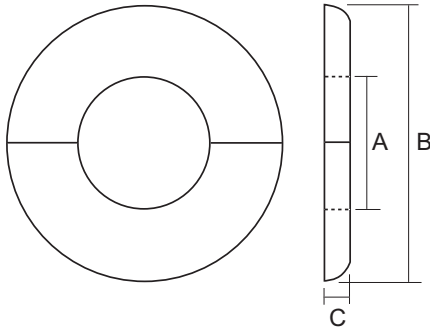

Floor and Ceiling Plates - Split Type w/Springs - FCP

Physical Data

Nominal Pipe Size		Dimensions (mm/inch)			Reference	Weight (kg/lb)
Metric	Inch	A	O.D. (B)	Depth (C)		
DN15	1/2"	25,0 / 0.98	70,0 / 2.75	6,0 / 0.24	FCP0050	0,035 / 0.077
DN20	3/4"	30,0 / 1.18	75,0 / 2.95	7,0 / 0.28	FCP0075	0,040 / 0.088
DN25	1"	37,5 / 1.48	85,0 / 3.35	8,0 / 0.31	FCP0100	0,049 / 0.108
DN32	1 1/4"	45,0 / 1.77	92,5 / 3.64	8,0 / 0.31	FCP0125	0,054 / 0.119
DN40	1 1/2"	50,0 / 1.97	97,5 / 3.84	8,0 / 0.31	FCP0150	0,058 / 0.127
DN50	2"	60,0 / 2.36	110,0 / 4.33	8,0 / 0.31	FCP0200	0,071 / 0.157
DN65	2 1/2"	80,0 / 3.15	132,5 / 5.22	8,0 / 0.31	FCP0250	0,091 / 0.201
DN80	3"	92,5 / 3.64	150,0 / 5.91	8,0 / 0.31	FCP0300	0,110 / 0.24
DN100	4"	120,0 / 4.72	185,0 / 7.28	8,0 / 0.31	FCP0400	0,229 / 0.50
DN125	5"	150,0 / 5.91	230,0 / 9.05	10,0 / 0.39	FCP0500	0,265 / 0.584
DN150	6"	172,5 / 6.80	250,0 / 9.84	10,0 / 0.39	FCP0600	0,356 / 0.785
DN200	8"	225,0 / 8.86	332,5 / 13.09	10,0 / 0.39	FCP0800	0,509 / 1.122